

type number	A	B	C	weight kg/pc	max. load kg	🔥
DT 100_F	120	120	60	0,30	250	🔥
DT 150_F	170	120	60	0,36	250	🔥
DT 200_F	220	120	60	0,43	250	🔥
DT 250_F	270	120	60	0,53	250	🔥
DT 300_F	320	135	60	0,73	325	🔥
DT 400_F	420	135	60	0,88	325	🔥
DT 500_F	520	155	90	1,30	350	🔥
DT 600_F	620	155	90	1,60	350	🔥
DT 800_F	820	155	90	1,90	250	🔥
DT 1000_F	1020	155	90	2,40	180	🔥



product description: Brackets DT are intended to create standardized or non standardized support construction.

Brackets DT + DT OKO are intended to create standardized support construction. DT + DT OKO have to be fixed by ZT into ceiling or wall in order to maintain functionality in fire as standardized support construction. DT + DT OKO is full replace for DTBS.

It is designated for installation on the wall or ceiling profile SPS.

Bracket DT is fixed to ceiling hanger (SPS) by S 10X20 until S 10X30 screws, ML10 nuts and PD 10 washers.

For a double-sided installation on ceiling SPS hanger should be used S 10X70 screws, ML10 nuts and PD 10 washers.

For assembly to the ceiling profile there are used the sliding nuts PM 41 M 10 (PMP 41 M 10) together with the bolts S 10X20 (S 10X25 or S 10X30).

NSM 6X10 bolts are used to attach the cable tray to the bracket. An SUP fastening clamp is suitable for attaching to a cable ladder. To protect the cables, the bolt head is inside the cable tray.

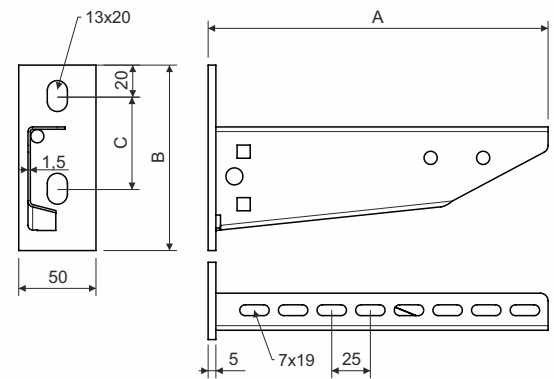

surface finish: F - Hot Dip Galvanized, zinc-layer 55 µm (min. 45 µm)

classification 🔥: ČSN 73 0895 P 90-R
DIN 4102-12 E 90
STN 92 0205 PS 90

Fire classification depends on the specific conditions of the cable tray, detailed in the catalog Systems with maintained functionality in fire

storage: ČSN EN 60721-3-1



 **WARNING****Risk of injury from cutting**

Although the cable trays are produced with maximum effort to minimize sharper edges, it is necessary to wear protective gloves to carry, grip and work with cable elements.

Risk of system collapse

It is essential to strictly adhere to the maximum load limits for individual cable support systems and ensure proper installation according to the installation manual.

Electricity injury

As individual components of cable management systems are made of electrical conductive material, it is essential not to work with a system near live electrical parts. Infringement of the safety regulations may cause serious injury of health or death.

Safe Use

Under normal and foreseeable conditions of use, there are no risks to consumers, provided that proper installation and usage are carried out in accordance with the installation manual.

recycling codes:



bracket DT



cardboard